

# Na Desítce

## Apartment A1.4

Ground floor | 2 rooms | 49.4 m<sup>2</sup>

01	Hall	3.2 m <sup>2</sup>
02	Living room with kitchen	24.9 m <sup>2</sup>
03	Bathroom	5.1 m <sup>2</sup>
04	Bedroom	13.1 m <sup>2</sup>
<b>Total usable area</b>		<b>46.3 m<sup>2</sup></b>
<b>Total floor area</b>		<b>49.4 m<sup>2</sup></b>
05	Terrace	15.6 m <sup>2</sup>
<b>Exterior in total</b>		<b>15.6 m<sup>2</sup></b>

Included in the apartment price is 1 outdoor parking space.

Included in the apartment price is 1 cellar cubicle.

Energy label C

**crescon**  
crescon.cz

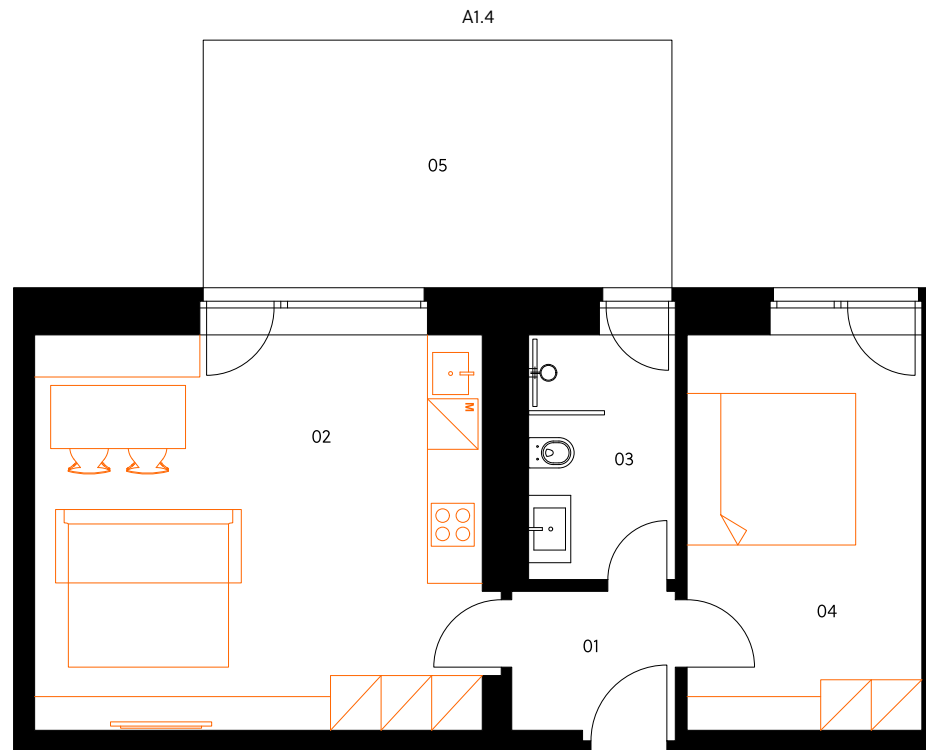

Situation

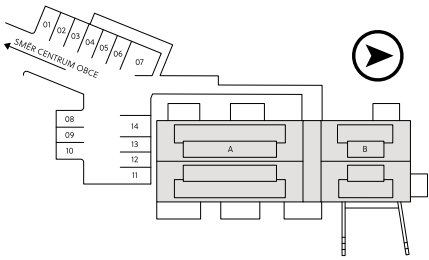

1. NP

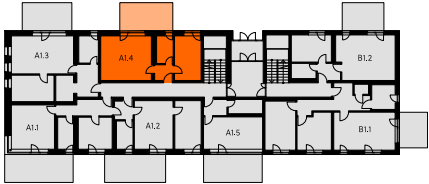

The orange elements in the unit floor plan are not part of the offer. The floor area, according to Government Regulation No. 366/2013 Coll., is the floor area bounded by the inner sides of the perimeter walls, including the floor area of all vertical load-bearing and non-load-bearing structures inside the unit.